

MGTL022V

Bi- Telecentric Lens

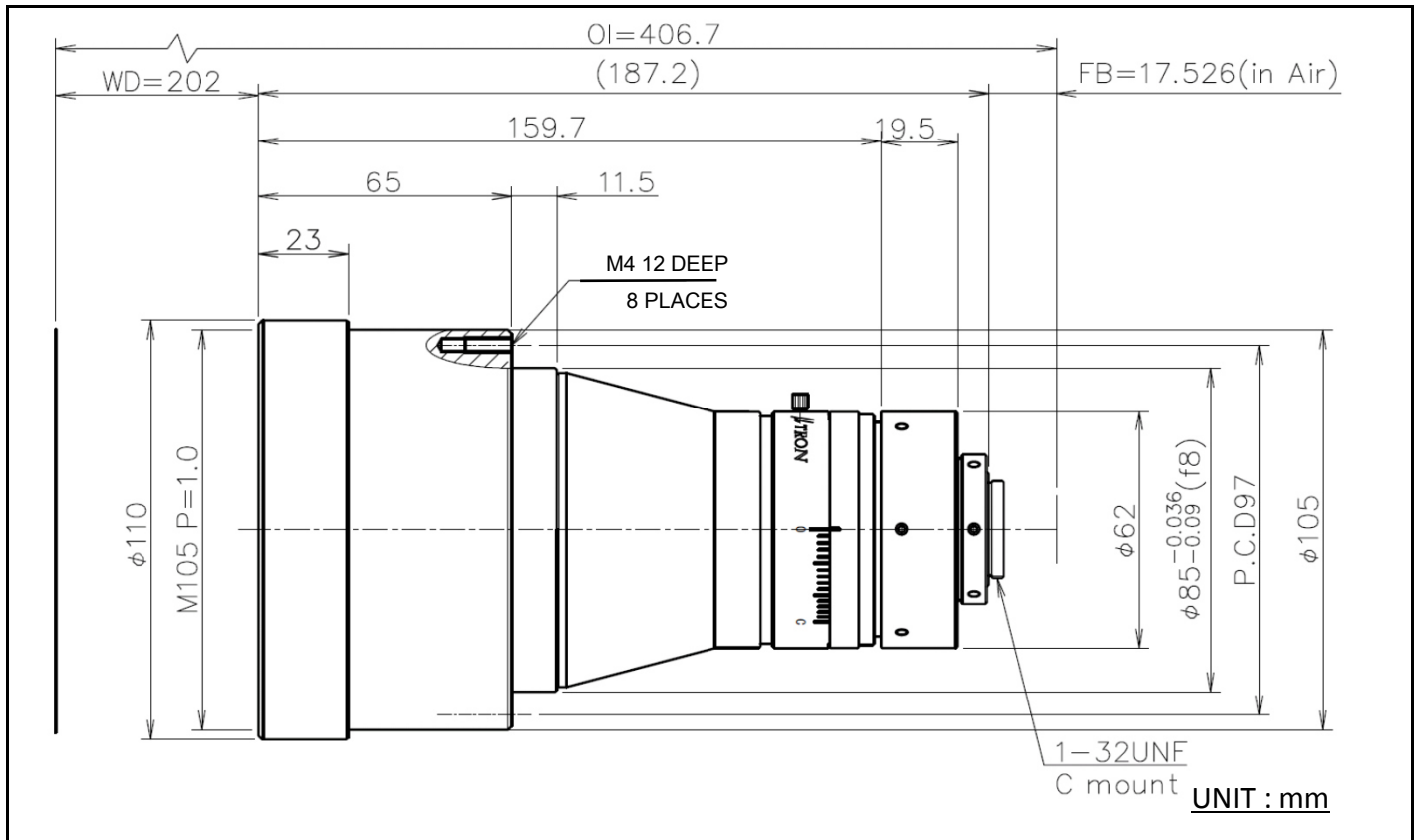

Model	MGTL022V
Magnification	0.22x
W D	202.0 mm
O I	406.7 mm
Effective FNo.	6.0
Object Side NA	0.018
Object Side Resolution	18 μ m
Depth of Field	9.9 mm
TV Distortion	0.00%
Image Circle	ϕ 17.6 mm
Weight	Approx. 1.4kg
Mount	C-mount
Filter Size	M105 P=1.0

- °Specifications mentioned above are design values.
- °Resolution indicates a theoretical resolution at a wavelength of 550nm.
- °Depth of field is calculated assuming permissible circle of confusion is 40 μ m.
- °Specifications and dimensions are subject to change without notice.

MaxxVision®

Sigmaringer Str. 121
70567 Stuttgart
Tel.: 0711 997 996 3
www.maxxvision.com