

# MV-CU020-19GM/GC

2 MP 1/2.8" CMOS GigE Area Scan Camera



GEN*i*CAM

GIG*E*  
VISION

## Introduction

MV-CU020-19GM/GC camera adopts Sony® IMX290 sensor to provide high-quality images. It uses GigE interface to transmit non-compressed images in real time, and its max. frame rate can reach 56 fps in full resolution.

## Key Feature

- Adopts low consumption platform with stable performance.
- Supports wide dynamic range, noise reduction and sharpness functions.
- Customized filter with strong anti-interference ability is optional.
- Supports hardware trigger, software trigger, free run, etc.
- Adopts GigE interface and max. transmission distance of 100 meters without relay.
- Compatible with GigE Vision V2.0 Protocol, GenICam Standard, and third-party software based on the protocol and standard.

## Dimension

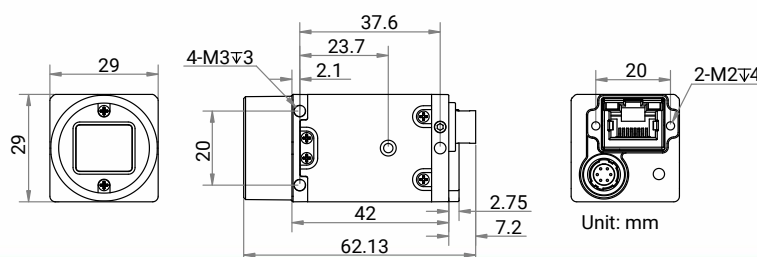

## Available Model

- Mono camera: MV-CU020-19GM
- Color camera: MV-CU020-19GC

## Applicable Industry

Mold protector, microscopy imaging, food and medicine package, etc.

## Sensor Quantum Efficiency

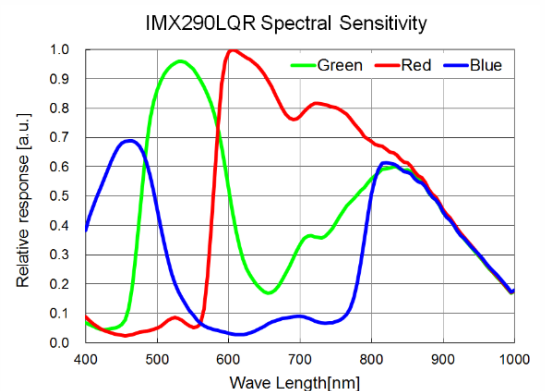

## Specification

Model	MV-CU020-19GM	MV-CU020-19GC
<b>Performance</b>		
Sensor type	CMOS, rolling shutter	
Sensor model	Sony® IMX290	
Pixel size	2.9 μm × 2.9 μm	
Sensor size	1/2.8"	
Resolution	1920 × 1080	
Max. frame rate	56 fps @1920 × 1080 Mono 8	
Dynamic range	90 dB	
SNR	41 dB	
Gain	0 dB to 24 dB	0 dB to 30 dB
Exposure time	64 μs to 130 ms	128 μs to 260 ms
Exposure mode	Off/Once/Continuous exposure mode	
Mono/color	Mono	Color
Pixel format	Mono 8	Mono 8, YUV422Packed
Binning	Supports 1 × 1, 2 × 2	Not supported
Decimation	Not supported	
Reverse image	Supports horizontal and vertical reverse image output	
<b>Electrical feature</b>		
Data interface	Gigabit Ethernet, compatible with Fast Ethernet	
Digital I/O	6-pin P7 connector provides power and I/O, including opto-isolated input × 1 (Line 0), opto-isolated output × 1 (Line 1), bi-directional non-isolated I/O × 1 (Line 2).	
Power supply	9 VDC to 24 VDC, supports PoE	
Power consumption	Typ. 2.1 W@12 VDC	
<b>Mechanical</b>		
Lens mount	C-mount	
Dimension	29 mm × 29 mm × 42 mm (1.1" × 1.1" × 1.7")	
Weight	Approx. 100 g (0.2 lb.)	
Ingress protection	IP30 (under proper lens installation and wiring)	
Temperature	Working temperature: 0 °C to 50 °C (32 °F to 122 °F) Storage temperature: -30 °C to 70 °C (-22 °F to 158 °F)	
Humidity	20% to 80% RH, non-condensing	
<b>General</b>		
Client software	MVS or third-party software meeting with GigE Vision Protocol	
Operating system	32/64-bit Windows XP/7/10, 32/64-bit Linux and 64-bit MacOS	
Compatibility	GigE Vision V2.0, GenICam	
Certification	CE, FCC, RoHS, KC	

**HIKROBOT**

Hangzhou Hikrobot Co., Ltd.  
en.hikrobotics.com

**MaxxVision®**

Sigmaringer Str. 121  
70567 Stuttgart  
Tel.: 0711 997 996 3  
www.maxxvision.com

© Hangzhou Hikrobot Co., Ltd. All Rights Reserved.

Hangzhou Hikrobot does not tolerate any infringement. Any organization or individual may not imitate or reproduce in whole or in part of the content. The data herein is based on Hikrobot's internal evaluation. Actual data may vary depending on specific configuration and operating condition. The information herein is subject to change without notice. All the content has been checked conscientiously. Nevertheless, Hikrobot shall not be liable to damages resulting from errors, inconsistencies or omissions.