

MV-CH250-90GM

25 MP 1.1" CMOS GigE Area Scan Camera



GEN*i*CAM

GIG*E*
VISION

Introduction

MV-CH250-90GM camera adopts Gpixel GMAX0505 sensor to provide high-quality image. It uses GigE interface to transmit non-compressed images in real time with max. frame rate reaching 4.5 fps.

Key Feature

- Supports manual adjustment for gain, exposure control, LUT, Gamma correction, etc.
- Resolution of 5120 × 5120 and pixel size of 2.5 μm × 2.5 μm
- Adopts GigE interface providing max. transmission distance of 100 meters without relay
- Supports hardware triggering, software triggering and free run mode
- Up to 128 MB local memory for burst transmission and retransmission

Available Model

Mono camera: MV-CH250-90GM

Applicable Industry

SMT/ PCB AOI, FPD, railway related applications, etc.

Sensor Quantum Efficiency

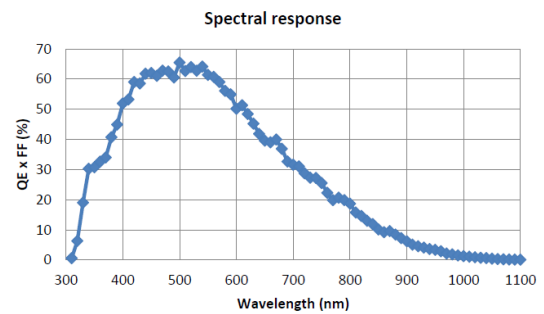

Dimension

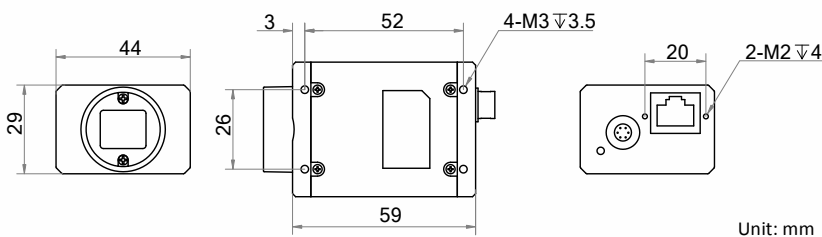

Specification

Model	MV-CH250-90GM
Camera	
Sensor type	CMOS, global shutter
Sensor model	Gpixel GMAX0505
Pixel size	2.5 μm \times 2.5 μm
Sensor size	1.1"
Resolution	5120 \times 5120
Max. frame rate	4.5 fps @5120 \times 5120
Dynamic range	63 dB
SNR	36 dB
Gain	7.9 dB to 13.9 dB
Exposure time	12 μs to 10 s
Mono/color	Mono
Shutter mode	Off/Once/Continuous exposure mode
Pixel format	Mono 8/10/10p/12/12p
Binning	Supports 2 \times 2, 4 \times 4
Decimation	Supports 2 \times 2, 4 \times 4
Reverse image	Supports horizontal and vertical reverse image output
Image buffer	128 MB
Electrical features	
Data interface	Gigabit Ethernet
Digital I/O	6-pin Hirose connector provides power and I/O, including opto-isolated input x 1 (Line0), opto-isolated output x 1 (Line1), and bi-directional non-isolated I/O x 1 (Line2)
Power supply	5 VDC to 15 VDC, supports PoE power supply
Power consumption	< 3.6 W@12 VDC
Structure	
Lens mount	C-mount
Dimension	29 mm \times 44 mm \times 59 mm (1.1" \times 1.7" \times 2.3")
Weight	< 100 g (0.2 lb.)
Ingress protection	IP30 (under proper lens installation and wiring)
Temperature	Working temperature: 0 $^{\circ}\text{C}$ to 50 $^{\circ}\text{C}$ (32 $^{\circ}\text{F}$ to 122 $^{\circ}\text{F}$) Storage temperature: -30 $^{\circ}\text{C}$ to 70 $^{\circ}\text{C}$ (-22 $^{\circ}\text{F}$ to 158 $^{\circ}\text{F}$)
Humidity	20% to 80% RH, without condensation
General	
Client software	MVS or third-party software meeting with GigE Vision Protocol
Operating system	32/64-bit Windows XP/7/10, 32/64-bit Linux and 64-bit MacOS
Compatibility	GigE Vision V2.0, GenICam
Certification	CE, FCC, RoHS, KC

HIKROBOT

Hangzhou Hikrobot Technology Co., Ltd.
No.399 Danfeng Road, Binjiang District, Hangzhou 310051, China.
en.hikrobotics.com

MaxxVision[®]
Sigmaringer Str. 121
70567 Stuttgart
Tel.: 0711 997 996 3
www.maxxvision.com

Copyright Hikrobot

Hangzhou Hikrobot Technology Co., Ltd. All Rights Reserved. Hangzhou Hikrobot Technology does not tolerate any infringement. Any organization or individual may not imitate or reproduce in whole or in part of the content. The data herein is based on Hikrobot's internal evaluation. Actual data may vary depending on specific configuration and operating condition. The information herein is subject to change without notice. All the content has been checked conscientiously. Nevertheless, Hikrobot shall not be liable to damages resulting from errors, inconsistencies or omissions.