

MV-CH160-60GM

16 MP 1.1" CMOS GigE Area Scan Camera



GEN< i >CAM

GigE
VISION

Introduction

MV-CH160-60GM camera adopts CMOS sensor to provide high-quality images. It uses GigE interface to transmit non-compressed images in real time, and its max. frame rate can reach 7.25 fps in full resolution.

Key Feature

- Resolution of 4000 × 4000, pixel size of 3.2 μm × 3.2 μm.
- Adopts GigE interface and max. transmission distance of 100 meters without relay.
- Supports hardware trigger, software trigger, and free run.
- Compatible with GigE Vision V2.0 Protocol, GenICam Standard, and third-party software based on the protocol and standard.

Dimension

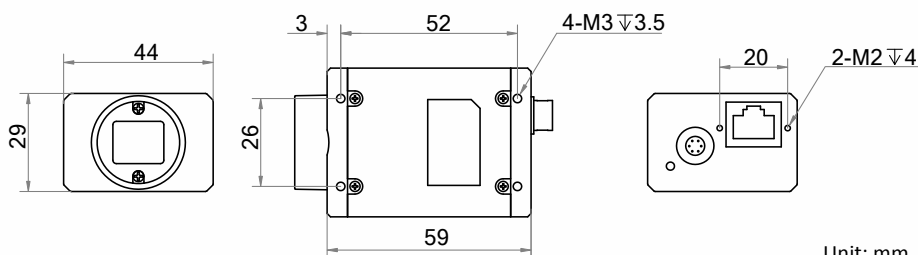

Available Model

MV-CH160-60GM

Applicable Industry

Lithium battery, SMT/ PCB AOI, FPD, railway related applications, etc.

Sensor Quantum Efficiency

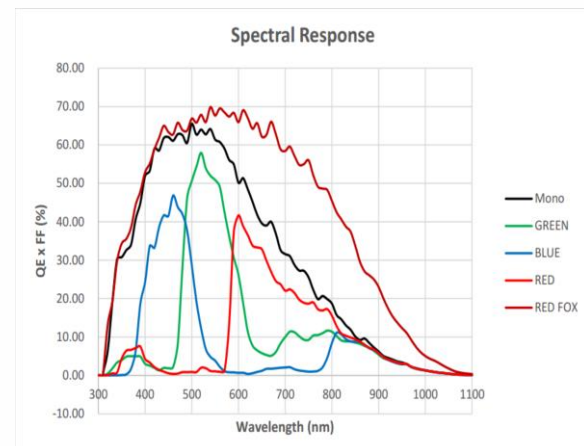

Specification

Model	MV-CH160-60GM
Camera	
Sensor type	CMOS, global shutter
Sensor model	HK
Pixel size	3.2 μm \times 3.2 μm
Sensor size	1.1"
Resolution	4000 \times 4000
Max. frame rate	7.25 fps @4000 \times 4000 Mono 8
Dynamic range	65 dB
SNR	38 dB
Gain	6 dB to 14 dB
Exposure time	12 μs to 10 sec
Exposure mode	Off/Once/Continuous exposure mode
Mono/color	Mono
Pixel format	Mono 8/10/12
Binning	Supports 1 \times 1, 2 \times 2, 4 \times 4
Decimation	Supports 1 \times 1, 2 \times 2, 4 \times 4
Reverse image	Supports horizontal and vertical reverse image output
Electrical feature	
Data interface	Gigabit Ethernet, compatible with Fast Ethernet
Digital I/O	6-pin P7 connector provides power and I/O, including opto-isolated input \times 1 (Line 0), opto-isolated output \times 1 (Line 1), bi-directional non-isolated I/O \times 1 (Line 2).
Power supply	9 VDC to 26 VDC, supports PoE
Power consumption	Typ. 3.72 W@12 VDC
Mechanical	
Lens mount	C-mount
Dimension	29 mm \times 44 mm \times 59 mm (1.1" \times 1.7" \times 2.3")
Weight	Approx. 100 g (0.2 lb.)
Ingress protection	IP30 (under proper lens installation and wiring)
Temperature	Working temperature: 0 $^{\circ}\text{C}$ to 50 $^{\circ}\text{C}$ (32 $^{\circ}\text{F}$ to 122 $^{\circ}\text{F}$) Storage temperature: -30 $^{\circ}\text{C}$ to 70 $^{\circ}\text{C}$ (-22 $^{\circ}\text{F}$ to 158 $^{\circ}\text{F}$)
Humidity	20% to 80% RH, non-condensing
General	
Client software	MVS or third-party software meeting with GigE Vision Protocol
Operating system	32/64-bit Windows XP/7/10, 32/64-bit Linux and 64-bit MacOS
Compatibility	GigE Vision V2.0, GenICam
Certification	CE, FCC, RoHS, KC

HIKROBOT

Hangzhou Hikrobot Co., Ltd.
en.hikrobotics.com

MaxxVision®

Sigmaringer Str. 121
70567 Stuttgart
Tel.: 0711 997 996 3
www.maxxvision.com