

MV-CH1010-10CM-M72-NF

101 MP CMOS Camera Link Area Scan Camera



GEN*i*CAM

CAMERA
Link

Introduction

MV-CH1010-10CM-M72-NF camera adopts Sony® IMX461 sensor to provide high-quality image. It uses Camera Link interface to transmit non-compressed images in real time, and its max. frame rate can reach 8 fps in full resolution.

Key Feature

- Adopts rolling shutter CMOS sensor providing wide dynamic range and high-quality image.
- Supports configuration modes of Base, Medium, Full and 80-bit via the Camera Link interface.
- Adopts compact design with mounting holes for flexible mounting.
- Compatible with Camera Link V2.0 Protocol, GenICam Standard, and the third-party software based on the protocol and standard.

Available Model

MV-CH1010-10CM-M72-NF

Applicable Industry

FPD, electronics and semiconductor inspection, research and scientific imaging, microscopy and metrology, etc.

Sensor Quantum Efficiency

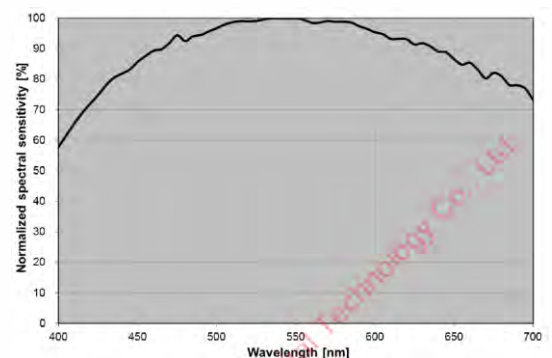

Dimension

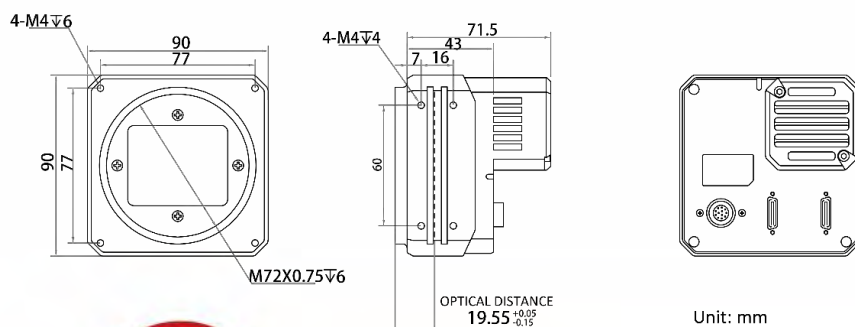

Specification

Model	MV-CH1010-10CM-M72-NF			
Camera				
Sensor type	CMOS, rolling shutter			
Sensor model	Sony® IMX461			
Pixel size	3.76 μm × 3.76 μm			
Sensor size	55 mm			
Resolution	11648 × 8740		11520 × 8740	
Configuration mode	Base	Medium	Full	80-bit
Tap geometry	2X_1Y	4X_1Y	8X_1Y	10X_1Y
Tap number	2 Taps	4 Taps	8 Taps	10 Taps
Max. frame rate	8 fps @11520 × 8740 Mono 8			
Pixel clock	40 MHz, 60 MHz, 70 MHz, 85 MHz			
Dynamic range	78 dB			
SNR	45 dB			
Gain	0 dB to 36 dB			
Exposure time	14 μs to 10 sec			
Mono/color	Mono			
Pixel format	ADC 12-bit mode: Mono 8/10/12; ADC 16-bit mode: Mono 8/10/12/16			
Exposure mode	Off/Once/Continuous exposure mode, supports global reset			
Binning	Supports 1 × 1, 1 × 2, 1 × 4, 2 × 1, 2 × 2, 2 × 4, 4 × 1, 4 × 2, 4 × 4			
Decimation	Supports 1 × 1, 1 × 2, 1 × 4, 2 × 1, 2 × 2, 2 × 4, 4 × 1, 4 × 2, 4 × 4			
Reverse image	Supports horizontal reverse image output			
Electrical feature				
Data interface	Camera Link with SDR interface			
Digital I/O	12-pin Hirose connector provides power and I/O, including opto-isolated input × 1 (Line 0), opto-isolated output × 1 (Line 1), bi-directional non-isolated I/O × 1 (Line 2), and RS-232 × 1.			
Power supply	12 VDC to 24 VDC			
Power consumption	Typ. 14 W@24 VDC			
Mechanical				
Lens mount	M72*0.75, optical back focal length 19.55 mm (0.8")			
Dimension	90 mm × 90 mm × 71.5 mm (3.5" × 3.5" × 2.8")			
Weight	Approx. 790 g (1.7 lb.)			
Ingress protection	IP40 (under proper lens installation and wiring)			
Temperature	Working temperature: 0 °C to 50 °C (32 °F to 122 °F) Storage temperature: -30 °C to 70 °C (-22 °F to 158 °F)			
Humidity	20% to 95% RH, non-condensing			
General				
Client software	MVS or frame grabber software meeting with GenICam Protocol			
Operating system	32/64-bit Windows 7/10			
Compatibility	Camera Link V2.0, GenICam			
Certification	CE, FCC, RoHS, KC			

HIKROBOT

Hangzhou Hikrobot Technology Co., Ltd.
No.399 Danfeng Road, Binjiang District, Hangzhou 310051, China.
en.hikrobotics.com

Copyright Hikrobot

Hangzhou Hikrobot Technology Co., Ltd. All Rights Reserved. Hangzhou Hikrobot Technology does not tolerate any infringement. Any organization or individual may not imitate or reproduce in whole or in part of the content. The data herein is based on Hikrobot's internal evaluation. Actual data may vary depending on specific configuration and operating condition. The information herein is subject to change without notice. All the content has been checked conscientiously. Nevertheless, Hikrobot shall not be liable to damages resulting from errors, inconsistencies or omissions.

MaxxVision®

Sigmaringer Str. 121

70567 Stuttgart

Tel.: 0711 997 996 3

www.maxxvision.com