

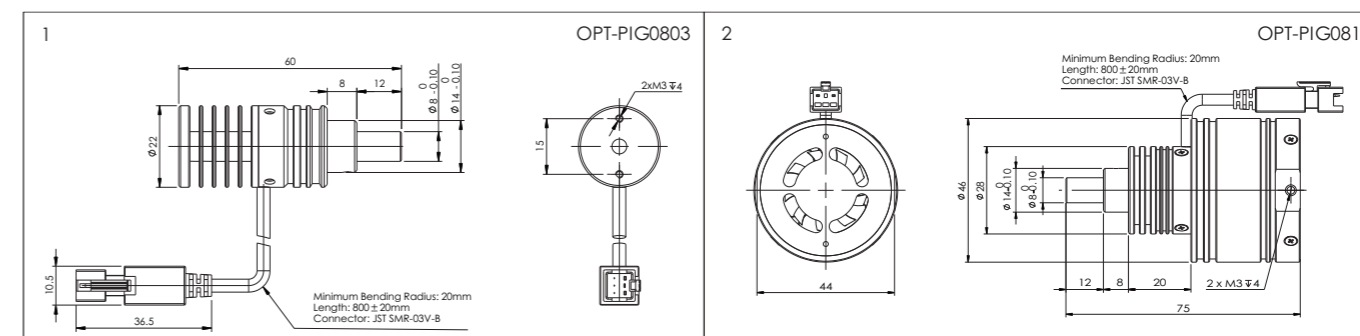

Model Table

No.	Model	Output	Color	Recommended Controller
1	OPT-PIG0803	0.7A/2.4W	●●●●	OPT-APA0705
2	OPT-PIG0810	0.8A/9.6W	●●●●	OPT-APA0812

Dimensional Drawings [mm]



Product Features

- 1 Five times higher intensity than standard lights
- 2 Housing temperature remains < 45°C thanks to elaborated heat release design
- 3 Over 400,000 lux thanks to special lighting-guide tube
- 4 Uniformity of > 85%

Application Areas

- ◆ Detection of condensate
- ◆ Screw surface defects inspection, convex and concave points inspection
- ◆ Pitch measurement of connectors
- ◆ Inspection of soldering points

Selection Guide

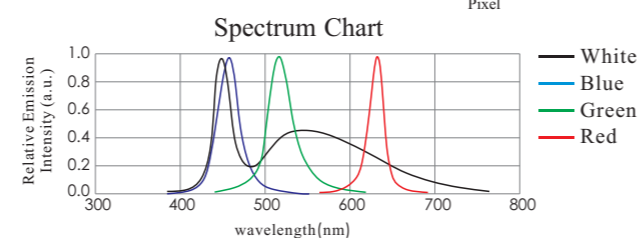
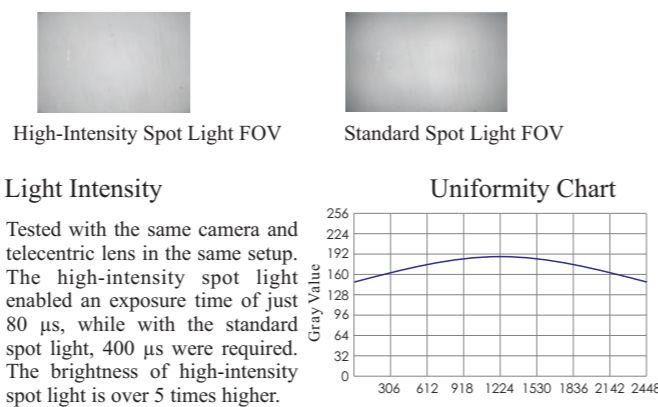
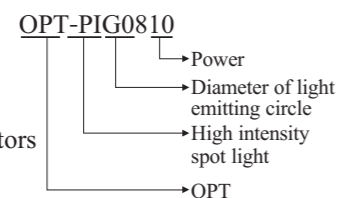

Customization Options

- Color
- Power
- Size
- Installation method
- Heat release

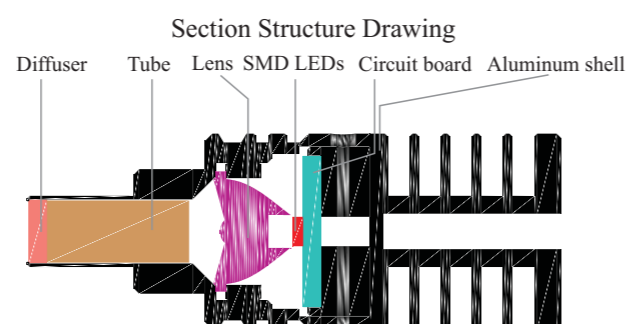

Application Examples

Inspected item: Surface inspection of fingerprint scanner



Original Image



Illuminated



Result Image