



BI-TELECENTRIC LENS FOR 2/3" TO 1/4" MATRIX DETECTORS

Model:	TC 23 72		
Magnification (X):	0.12		
Object Field (mm):	1/4" (3,6 x 2,7):	29.5	x 22.1
	1/3" (4,8 x 3,6):	39.3	x 29.5
	1/2" (6,4 x 4,8):	52.4	x 39.3
	1/1.8" (7,13 x 5,37):	58.3	x 43.9
	2/3" (8,8 x 6,6):	72.0	x 54.0
Working Distance (mm):	227.7 +/- 7		
Working F-number:	8		
MTF @70 lp/mm (%):	>40		
Field Depth (mm):	48.0 @ F/ 8		
Image side N.A.:	0.062		
Object side N.A.:	0.008		
Telecentricity (degree):	<0,08		
Distortion (%):	<0,07		
Mount:	C		
Length (mm):	299		
Maximum external diameter (mm):	116		
Weigh (g):	1600		

NOTES:

- 1) The inner aperture diaphragm can be supplied on request with smaller apertures in order to achieve a larger Field Depth
- 2) Compatible with LT RN 64 diffusive ring light
- 3) Specific "Teleclamp80" mechanical interface available
- 4) Can be coupled to a collimated light illuminator like LT CL 80
- 5) Compatible with Diffuse Coaxial LT CX 64 Illuminator

Rev No.	Description	Date	Name
A	First light	10/03/06	A.Vismara

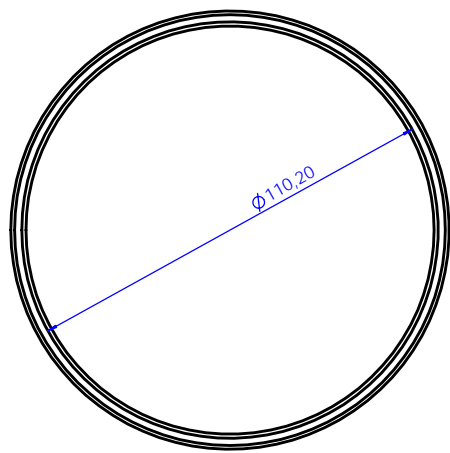
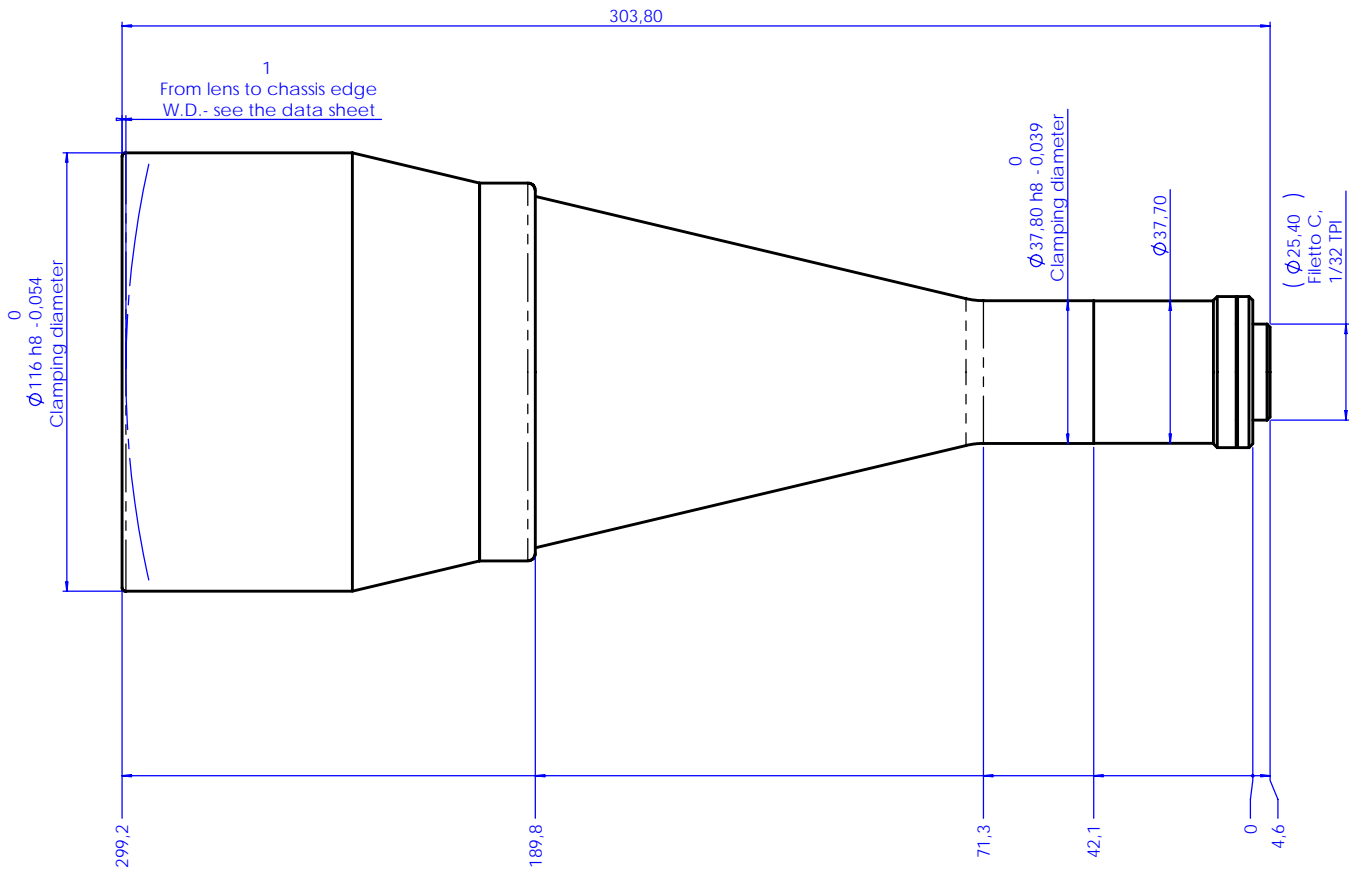

Material	N.A.	Mass	1.6 kg	Scale	1:1
Surface treatment	N.A.	Project-Prod.Item/Instrument	Telecentric lens 23 72		
Geometrical tolerance (ISO 2768-2)		Class	K	Undimensioned Bevels	1x45°
Linear tolerance (ISO 2768-2)		Class	m	Undimensioned Radii	R 0.5
0.5	>3-	>6-	>30-	>120	>400-
-3	6	30	120	400	1000
±0.1	±0.1	±0.2	±0.3	±0.5	±0.8
		Class	m	±1.2	±2
		Date	Name		
		Designed	10/03/06	A.Vismara	
		Draw	10/03/06	A.Vismara	
		Checked	x	C.Sedazzari	
		Drawing No.		Sheet	
		02451-0-A		1/1	
www.opto-engineering.com					
OPTO ENGINEERING S.r.l. - 46100 Mantova Italy - Via Cremona, 28 - Tel/fax +39 0376 229585 - e-mail: info@opto-engineering.com - http://www.opto-engineering.com					