

MaxxVision®

INTRODUCTION

The new Sony FCB-EX1000P colour block camera combines an incredibly powerful 36x zoom lens with a wide/telephoto horizontal field of view, ideally suited for use in security domes and traffic monitoring applications.

The FCB-EX1000P incorporates a high-sensitivity 1/4-type EXview HAD™ CCD, which allows images to be captured at a minimum illumination as low as 0.1 lx.* With a newly developed slow AE response function, the camera can adapt to abrupt changes in light while capturing fine image details. In addition, the FCB-EX1000P is equipped with a variety of convenient features such as spherical privacy zone masking, Electronic-Flip, Picture Freeze, and Auto IR-Cut Filter Removal, all of which have been inherited from current Sony FCB-EX Series cameras.

* When the shutter speed is set to 1/4 s.

FEATURES

- 1/4-type EXview HAD CCD
- FCB-EX1000P: 440,000 pixels
- Minimum Illumination
 - 1/60 s shutter speed: 1.4 lx (typical) (F1.6, 50 IRE)
 - 1/4 s shutter speed: 0.1 lx (typical) (F1.6, 50 IRE)
- 36x Optical Auto Focus Zoom Lens
 - f = 3.4 mm (wide) to 122.4 mm (tele)
 - F1.6 to F4.5
 - Angle of view (H): 57.8° (wide) to 1.7° (tele)
 - 432x Zoom Ratio (36x optical, 12x digital)
- Slow AE Response Function**

The FCB-EX1000P is equipped with a Slow AE response function to automatically slow the rate at which camera exposure levels change. This rate can be set up to 32 times slower than when Full-Auto AE or Priority (shutter/iris) modes are selected.*** The Slow AE response function is useful when monitoring areas in which lighting conditions change abruptly. For example, if the camera is used to monitor the flow of nighttime traffic when vehicle headlights are pointed directly towards it, the camera's exposure level is reduced slowly. This can allow users to monitor and identify crucial parts of the image that surround the headlights, such as the car's license plate or the driver's face.

** This function can be set using VISCA™ protocol.

*** The rate at which camera exposure levels are adjusted when in Full-Auto AE or Priority modes is just under one second.

- Auto IR Cut Filter Removal (ICR)

For optimised sensitivity in both day and night shooting applications, these cameras incorporate an Auto ICR function. At a set level of darkness, the IR Cut filter is automatically disabled (ICR ON) and the infrared sensitivity is increased. Conversely, at a set level of brightness, the filter is automatically enabled (ICR OFF). The ICR function will automatically engage itself depending on the level of ambient light, so that the camera can be effective in a variety of lighting conditions.

- Spherical Privacy Zone Masking

Unwanted or prohibited areas within an image can be masked precisely and appropriately. If the FCB-EX1000P is integrated into a Pan/Tilt/Zoom (PTZ) camera system, this technology can keep masking areas interlocked with PTZ movements regardless of the camera angle.

- High-Speed Serial Interface (max. 38.4 kb/s) and TTL Signal-Level Control (VISCA protocol)
- Electronic-Flip (E-Flip) Function
- Alarm Function
- Picture Freeze Function
- SPOT AE Function
- Electronic Shutter/Slow Shutter
- Internal/External Sync



FCB-EX1000P

COLOUR BLOCK CAMERA

www.sonybiz.net/vision



SPECIFICATIONS

Image sensor	1/4-type EXview HAD CCD
Signal system	PAL
Number of total pixels	Approx. 440,000 pixels
Lens	36x optical zoom, f=3.4 mm (wide) to 122.4 mm (tele), F1.6 to F4.5
Digital zoom	12x (432x with optical zoom)
Angle of view (H)	57.8° (wide end) to 1.7° (tele end)
Minimum working distance	320 mm (wide end) to 1,500 mm (tele end)
Sync system	Internal / External (V-lock)
Minimum illumination	1/60 s mode: 1.4 lx (typical) (F1.6, 50 IRE) 1/4 s mode: 0.1 lx (typical) (F1.6, 50 IRE)
S/N ratio	More than 50 dB
Electronic shutter	1/1 to 1/10,000 s, 22 steps
White balance	Auto, ATW, Indoor, Outdoor, One-push, Manual
Gain	Auto / Manual (-3 to 28 dB, 2 dB steps)
AE control	Auto, Manual, Priority mode, Bright, EV compensation, Backlight compensation, Slow AE
EV compensation	-10.5 to 10.5 dB (1.5 dB steps)
Backlight compensation	On / Off
Privacy zone masking	On / Off (24 positions)
Flicker cancel	Auto
Focusing system	Auto (Sensitivity: normal, low), One-push AF, Manual, Infinity, Interval AF, Zoom trigger AF
Picture effects	E-Flip, Nega Art, Black & White, Mirror Image
Camera operation switch	Zoom tele, Zoom wide
Video output	VBS: 1.0 Vp-p (sync negative), Y/C
Camera control interface	VISCA (TTL signal level), baud rate: 9.6 Kb/s, 19.2 Kb/s, 38.4 Kb/s, 1 or 2 Stop bit selectable
Storage temperature	-20 to 60 °C (-4 to 140 °F)
Operating temperature	0 to 50 °C (32 to 122 °F)
Power consumption	6 to 12 V DC/1.6 W (motors inactive), 4.0 W (motors active)
Mass	230 g (8.1 oz)
Dimensions (W x H x D)	50.0 x 57.5 x 87.9 mm (2 x 2 3/8 x 3 1/2 inches)

DIMENSIONS

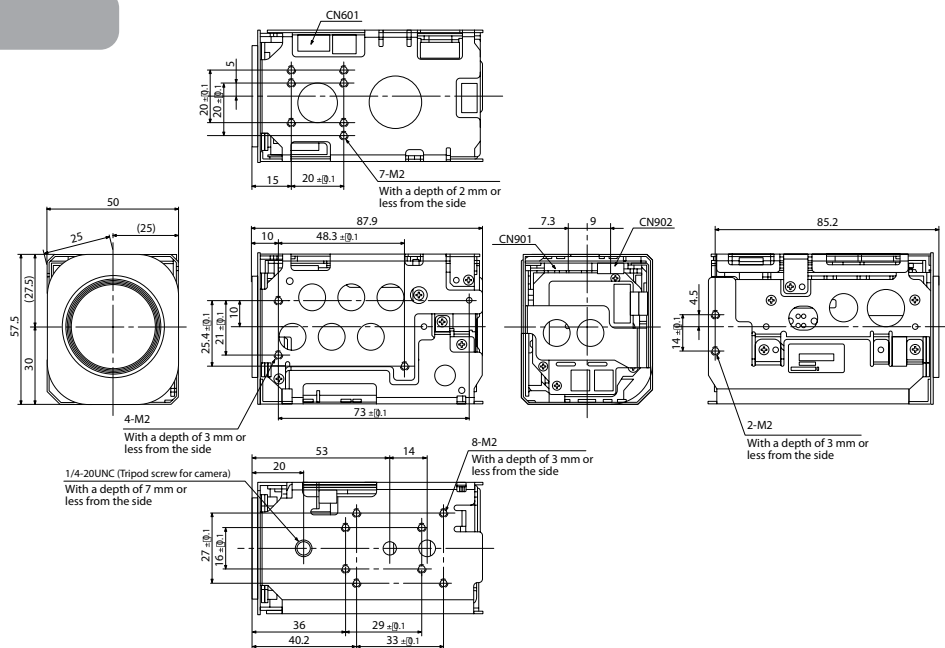

MaxxVision GmbH
 Sigmaringer Straße 121
 D-70567 Stuttgart, Germany
 Fon: +49-(0)711-997 996-3
 Fax: +49-(0)711-997 996-50
 E-Mail: info@maxxvision.com
 www.maxxvision.com

MaxxVision®